

TECHNICAL DATA SHEET

S.3905W

MICROSLOT DOWNLIGHT

SIMES

luce per l'architettura

-PRODUCT TYPE

Down-light luminaire .
IP rating IP 65

-MATERIAL CHARACTERISTICS

Aluminium die cast housing in EN AB-47100 and extruded EN AW-6060 with high resistance against corrosion.

Stone wash surface treatment prior to painting process.

A4 grade Stainless Steel screws with 2,5-3% molybdenum content which increases the resistance against corrosion.

Silicone gaskets.

Painting Process :

3 Step Process

1) Surface treatment with BONDERITE . A heavy metal free chemical surface treatment containing ceramic nano particles giving a cohesive, inorganic and highly dense protective coating .

2) PRE POLYMERIZATION a process of introducing an epoxy primer with excellent characteristics to the paint which also offers very high resistance to oxidation due to its Zinc content.

3) POLYMERIZATION a process with the application of polyester powder with high resistance against UV rays and harsh weather conditions. Improved protection for Marine applications.

Mechanical resistance of glass IK 08

-LIGHTING PERFORMANCE

Clear toughened glass 6 mm thick.

LOR --

-WIRING

Single cable entry ($\varnothing 8 \div 12$ mm).

Isolation: CLASS I .

Available colours: ALUMINIUM GREY (cod.14), ANTHRACITE GREY (cod.24).

Weight: 1.11 Kg

Glow Wire test: 850°C

Class 2 L.E.D circuit included. (CEI EN 60825-1:2003-02)

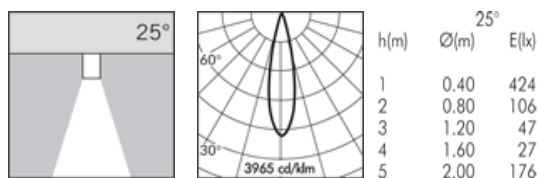

* Photometric measured using COLD WHITE LED 6650K

3 ACCENT LED3200K 3,6W
Electronic transformer 100/240V 50÷60Hz

IP 65

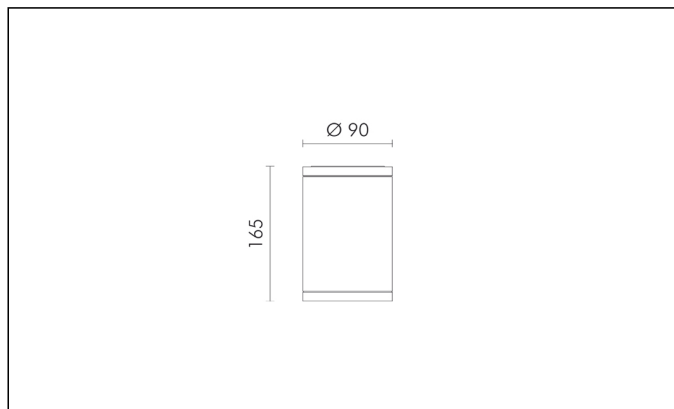

LAST UPDATE 14/09/2010

SIMES S.p.A.
Via G.Pastore 2/4
25040 - Corte Franca - BRESCIA (ITALY)
<http://www.simes.com> - e-mail: simes@simes.com

Tel:
Export Sales: +39 0309860440
Technical Dep.: +39 0309860450
Lighting Design Dep.: +39 0309860425

Fax:
Export Sales: +39 0309860449
Technical Dep.: +39 0309860459
Lighting Design Dep.: +39 0309860429



The present technical data sheet and all the information contained is property of SIMES S.p.A. All rights reserved.
We reserve the right to change specifications without prior written notice.

TECHNICAL DATA SHEET

S.3905W

FURTHER INFORMATION

FIXING BASE

SIMES
luce per l'architettura

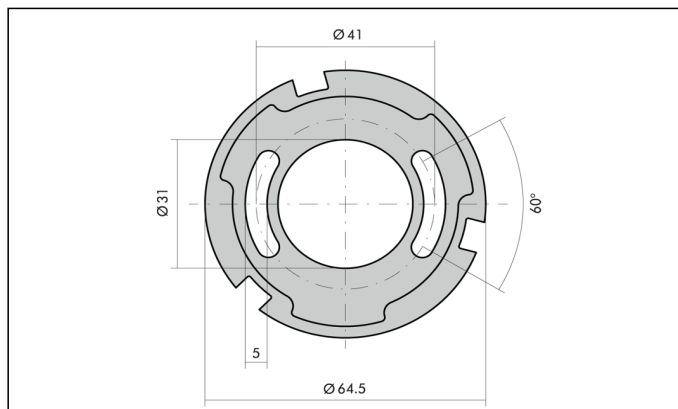

LAST UPDATE 14/09/2010

SIMES S.p.A.
Via G.Pastore 2/4
25040 - Corte Franca - BRESCIA (ITALY)
<http://www.simes.com> - e-mail: simes@simes.com

Tel:
Export Sales: +39 0309860440
Technical Dep. +39 0309860450
Lighting Design Dep.: +39 0309860425

Fax:
Export Sales: +39 0309860449
Technical Dep.: +39 0309860459
Lighting Design Dep.: +39 0309860429



The present technical data sheet and all the information contained is property of SIMES S.p.A. All rights reserved.
We reserve the right to change specifications without prior written notice.