

S I M E S

**TIRAFONDI  
PLANTED ROOT**

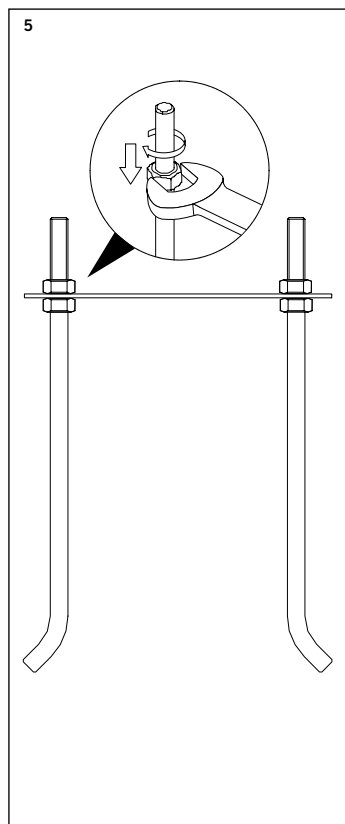

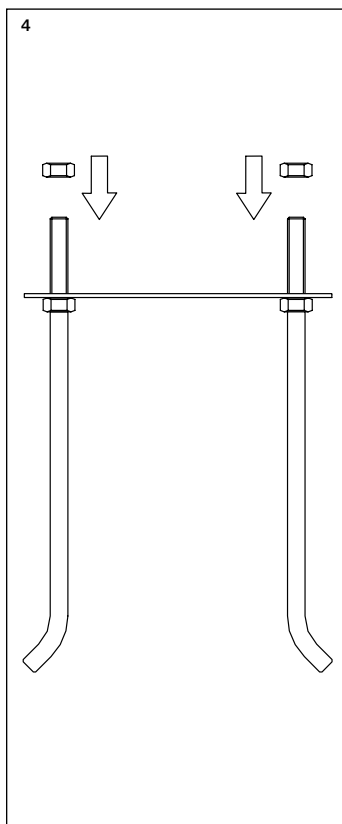
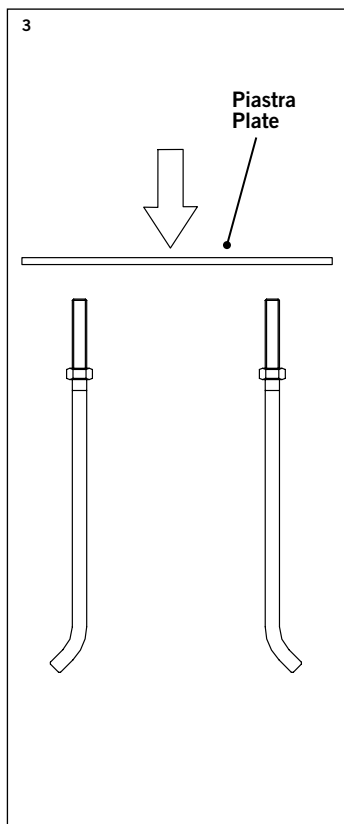
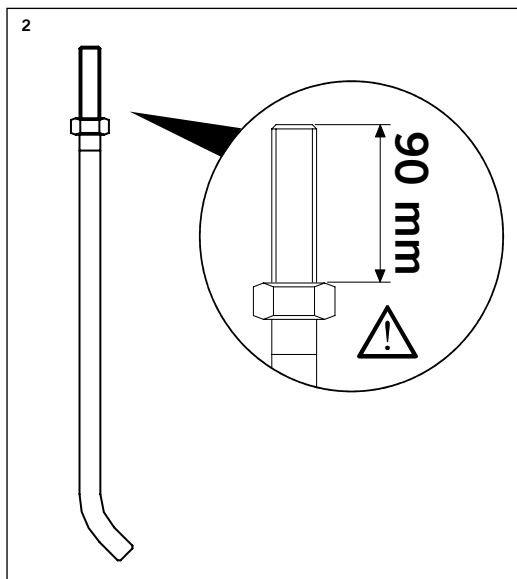
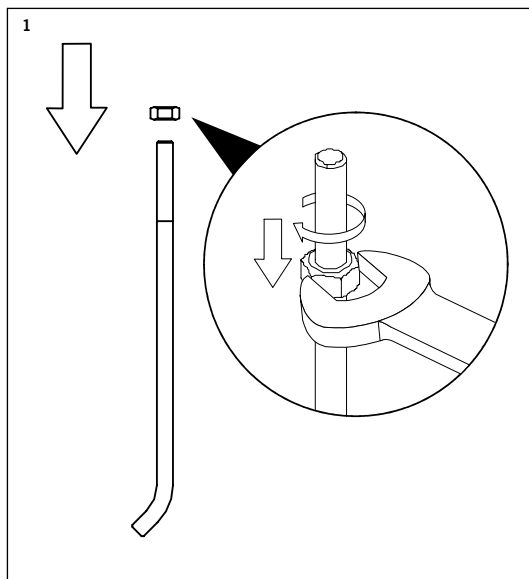
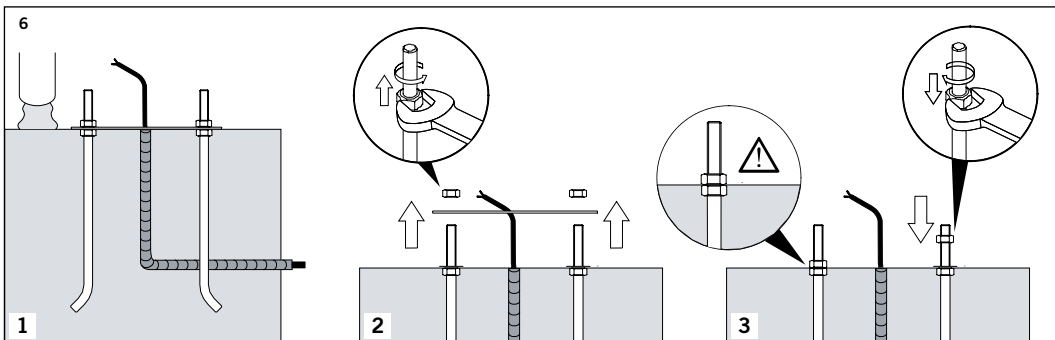

Dopo aver predisposto il tubo currogato max 60mm centrale alla piastra. Realizzare il plinto di cemento armato con profondità 0,7m e lato 1m proteggendo i filetti dei tirafondi con del nastro adesivo. Le dimensioni del plinto possono essere ottimizzate a seconda della consistenza del terreno, seguendo le indicazioni delle normative UNI EN 40.

After positioning of the tube for main cable max 60 mm in the centre of the plate.

Prepare the reinforced concrete footstall deep 0,7m and the side 1m (protect the threads of the planted root with adhesive tape).

The dimensions of the concrete footstall can be optimized according to the ground properties and in compliance with UNI EN 40 norms.

**plinto di cemento**  
**concrete footstall**

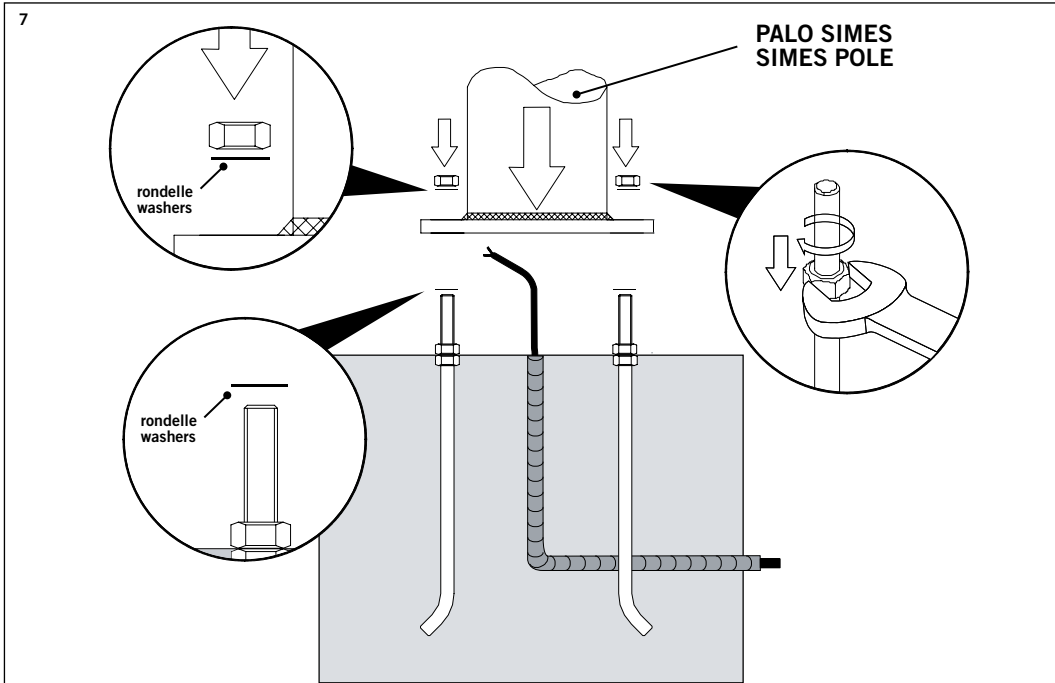
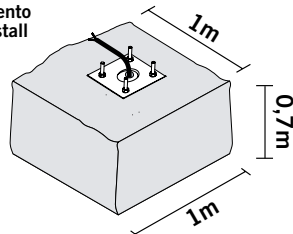

9

**OK**

PALO SIMES  
SIMES POLE

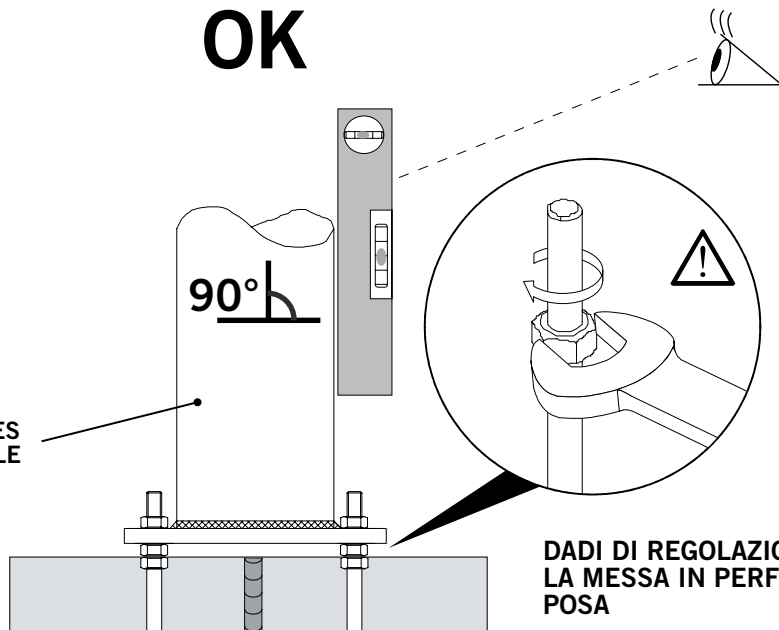

**DADI DI REGOLAZIONE PER  
LA MESSA IN PERFETTA  
POSA**

**NUTS TO BE ADJUSTED FOR  
A PERFECT VERTICAL  
INSTALLATION**

10

BETONCINO CEMENTIZIO  
TIPO EMACO®  
FAST CONCRETE  
TYPE EMACO®

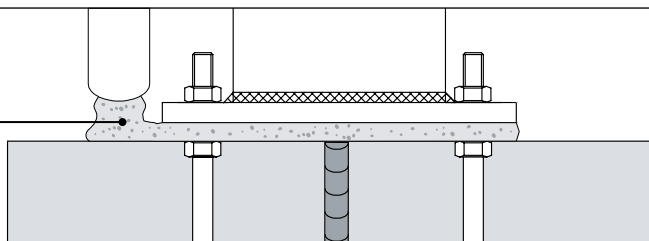

SIMES S.p.A. VIA G. PASTORE 2/4 - 25040 CORTE FRANCA (BRESCIA) - ITALY  
TEL. +39 0309860430 - FAX +39 0309860439  
E-mail: [simes@simes.it](mailto:simes@simes.it) - <http://www.simes.it>