



# NANOLED



Polycarbonate structure and diffuser.  
 Marine grade stainless steel AISI 316L  
 front ring 2 mm thick.  
 Luminaire hard wired with Factory-  
 sealed with B component epoxy resin  
 HO7RN-F 3,0m cable.  
 The polycarbonate body is cast  
 together with the stainless steel ring as  
 a single piece.  
 Absence of screws (the luminaire is  
 fixed to the recessing box through clips).  
 Recessing box in polypropylene.  
**LED versions supplied with LED circuit  
 24V d.c., power supply not included.**

IP67  
 CLASS III   
 IK 09



Theater, Vicenza, Italy © Crea Snc.



Maximum weight 1000 Kg

FINISHING:

 Stainless steel (code 19)

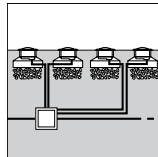

The recessing box must be placed at  
 ground level.  
 20 cm drainage gravel must be used  
 under the recessing box to allow easy  
 water evacuation.  
 Connection to the main line has to be  
 done into junction boxes.

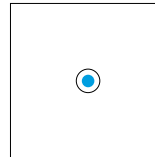

**LED BLUE**  
 versions available  
 on request.



**S.3400**  
**SIMPLE REMOTE POWER SUPPLY**  
**10W 240V/24V d.c.**  
 Dimensions 120x35x20mm  
**IP20**





**S.3422**  
**BOX WITH DIMMABLE REMOTE**  
**POWER SUPPLY 40W 240V/24V d.c.**  
 Dimensions 260x260x90mm  
**IP55**

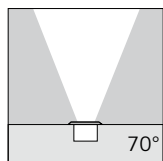
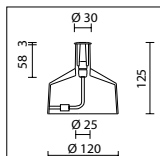

**S.3401**  
**BOX WITH SIMPLE REMOTE POWER**  
**SUPPLY 10W 240V/24V d.c.**  
 Dimensions 200x200x90mm  
**IP55**

WALK OVER - Opal diffuser



**S.3280.19**   
 With 1 led white 6000K 18lm  
 Rated luminaire luminous flux 3lm  
 Rated input power 0,5W **24V**

T 34°C

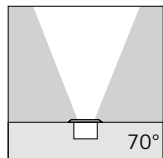

**S.3280W.19**   
 With 1 led white 3200K 10lm  
 Rated luminaire luminous flux 2lm  
 Rated input power 0,5W **24V**

T 34°C

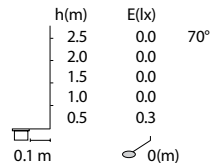
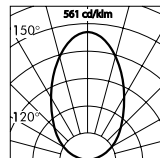
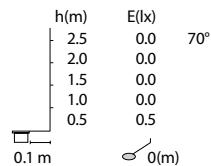
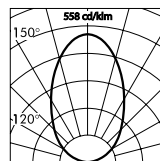

Requires remote power supply  
 240V/24V DC  
 (type S.3400 or S.3422)

WALK OVER - Opal diffuser

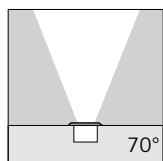
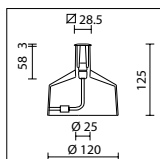

**S.3286.19**   
 With 1 led white 6000K 18lm  
 Rated luminaire luminous flux 3lm  
 Rated input power 0,5W **24V**

T 34°C

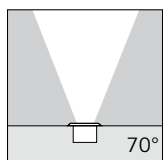

**S.3286W.19**   
 With 1 led white 3200K 10lm  
 Rated luminaire luminous flux 2lm  
 Rated input power 0,5W **24V**

T 34°C

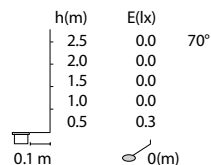
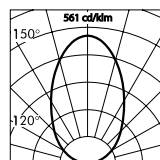
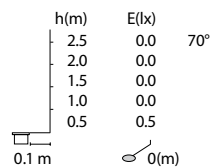
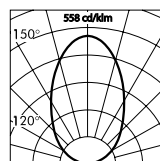

Requires remote power supply  
 240V/24V DC  
 (type S.3400 or S.3422)

Polycarbonate structure and diffuser.  
Marine grade stainless steel AISI 316L  
front ring 2 mm thick.

The polycarbonate body is cast  
together with the stainless steel ring as  
a single piece.

Absence of screws (the luminaire is  
fixed to the recessing box through clips).  
Recessing box in polypropylene.

Wall recessed versions hard wired  
with Factory-sealed with B component  
epoxy resin H07RN-F 1,0m cable.

Down-light version supplied with  
clips for installation in false-ceilings  
5±20mm thick with a Ø 38 mm hole.

**LED versions supplied with LED circuit  
24V d.c., power supply not included.**

IP67

CLASS III 

IK 09



"Therasia Resort Sea & SPA", Vulcano Island, Italy © Simes



Maximum weight 1000 Kg

FINISHING:

 Stainless steel (code 19)

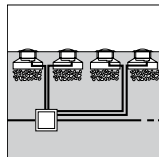

The recessing box must be placed at  
ground level.  
20 cm drainage gravel must be used  
under the recessing box to allow easy  
water evacuation.  
Connection to the main line has to be  
done into junction boxes.

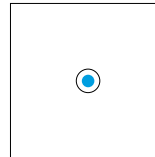

**LED BLUE**  
versions available  
on request.



**S.3400**  
**SIMPLE REMOTE POWER SUPPLY**  
**10W 240V/24V d.c.**  
Dimensions 120x35x20mm  
**IP20**



**S.3422**  
**BOX WITH DIMMABLE REMOTE**  
**POWER SUPPLY 40W 240V/24V d.c.**  
Dimensions 260x260x90mm  
**IP55**



**S.3401**  
**BOX WITH SIMPLE REMOTE POWER**  
**SUPPLY 10W 240V/24V d.c.**  
Dimensions 200x200x90mm  
**IP55**

WALK OVER - Opal diffuser

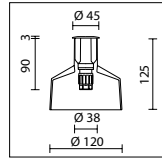
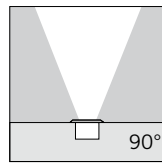

**S.3230.19**   
 With 1 led white 6000K 80lm  
 Rated luminaire luminous flux 29lm

**S.3230W.19**   
 With 1 led white 3200K 60lm  
 Rated luminaire luminous flux 18lm

Rated input power 1,25W **24V**  
 T 40°C

Requires remote power supply  
 240V/24V DC  
 (type S.3400 or S.3422)

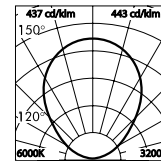

h(m)	E(lx) 6000K	E(lx) 3200K
2.5	0	0
2.0	0	0
1.5	0	0
1.0	1	1
0.5	4	3

0.1 m 0(m) 0(m)

WALK OVER - Transparent diffuser

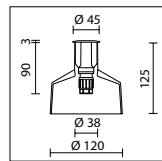
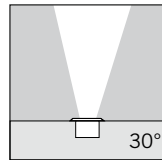
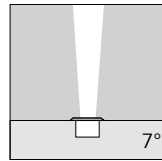

**S.3240.19**   
 With 1 led white 6000K 80lm  
 Rated luminaire luminous flux 56lm

**S.3240W.19**   
 With 1 led white 3200K 60lm  
 Rated luminaire luminous flux 35lm

**S.3264.19**   
 With 1 led white 6000K 80lm  
 Rated luminaire luminous flux 53lm

**S.3264W.19**   
 With 1 led white 3200K 60lm  
 Rated luminaire luminous flux 33lm

Rated input power 1,25W **24V**  
 T 40°C

Requires remote power supply  
 240V/24V DC  
 (type S.3400 or S.3422)

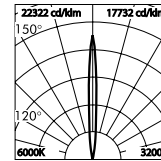

h(m)	E(lx) 6000K	E(lx) 3200K
5.0	0.0	0.0
4.0	0.5	0.0
3.0	1.0	1.0
2.0	4.0	3.0
1.0	24.0	15.0

0.1 m 0(m) 0(m)

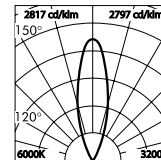

h(m)	E(lx) 6000K	E(lx) 3200K
2.5	0.0	0.0
2.0	0.5	0.0
1.5	1.0	1.0
1.0	5.0	3.0
0.5	30.0	18.0

0.1 m 0(m) 0(m)

WALL RECESSED - Transparent diffuser with asymmetric light distribution

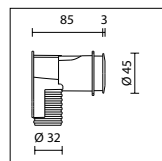
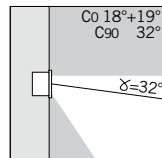

**S.3254.19**   
 With 1 led white 6000K 80lm  
 Rated luminaire luminous flux 29lm

**S.3254W.19**   
 With 1 led white 3200K 60lm  
 Rated luminaire luminous flux 20lm

Rated input power 1,25W **24V**

Requires remote power supply  
 240V/24V DC  
 (type S.3400)

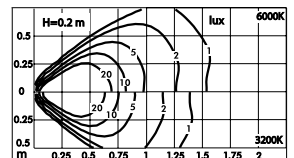
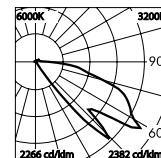

DOWN LIGHT - Opal diffuser

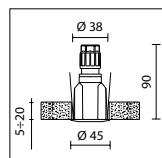
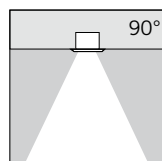

**S.3260.19**   
 With 1 led white 6000K 80lm  
 Rated luminaire luminous flux 29lm

**S.3260W.19**   
 With 1 led white 3200K 60lm  
 Rated luminaire luminous flux 18lm

Rated input power 1,25W **24V**

Requires remote power supply  
 240V/24V DC  
 (type S.3400 or S.3422)

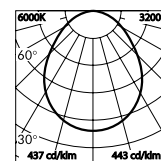

h(m)	Ø(m)	E(lx) 6000K	E(lx) 3200K
0.4	0.83	79	50
0.8	1.66	20	12
1.2	2.49	9	6
1.6	3.33	5	3
2.0	4.16	3	2



WALK OVER - Opal diffuser

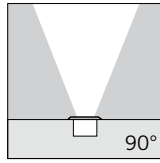
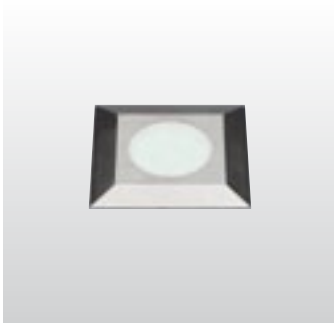

**S.3236.19** □  
With 1 led white 6000K 80lm  
Rated luminaire luminous flux 29lm

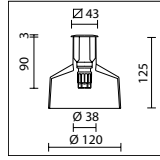

**S.3236W.19** □  
With 1 led white 3200K 60lm  
Rated luminaire luminous flux 18lm

Rated input power 1,25W 24V  
T 40°C

Requires remote power supply  
240V/24V DC  
(type S.3400 or S.3422)

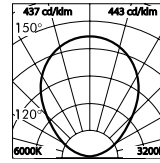

h(m)	E(lx) 6000K	90°	E(lx) 3200K	90°
2.5	0	0	0	0
2.0	0	0	0	0
1.5	0	0	0	0
1.0	1	1	1	1
0.5	4	3	3	3

0.1 m

WALK OVER - Transparent diffuser

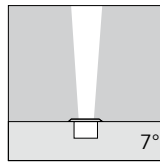

**S.3246.19** □  
With 1 led white 6000K 80lm  
Rated luminaire luminous flux 56lm

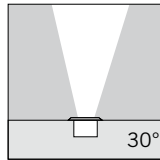

**S.3265.19** □  
With 1 led white 6000K 80lm  
Rated luminaire luminous flux 53lm

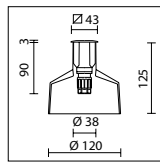

**S.3265W.19** □  
With 1 led white 3200K 60lm  
Rated luminaire luminous flux 33lm

Rated input power 1,25W 24V  
T 40°C

Requires remote power supply  
240V/24V DC  
(type S.3400 or S.3422)

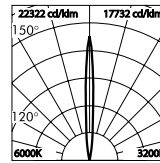

h(m)	E(lx) 6000K	7°	E(lx) 3200K	7°
5.0	0.0	0.0	0.0	0.0
4.0	0.5	0.0	0.0	0.0
3.0	1.0	1.0	1.0	1.0
2.0	4.0	3.0	3.0	3.0
1.0	24.0	15.0	15.0	15.0

0.1 m

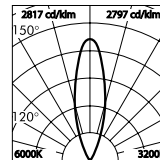

h(m)	E(lx) 6000K	30°	E(lx) 3200K	30°
2.5	0.0	0.0	0.0	0.0
2.0	0.5	0.0	0.0	0.0
1.5	1.0	1.0	1.0	1.0
1.0	5.0	3.0	3.0	3.0
0.5	30.0	18.0	18.0	18.0

0.1 m

WALL RECESSED - Transparent diffuser  
with asymmetric light distribution

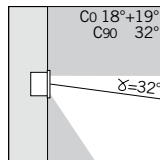
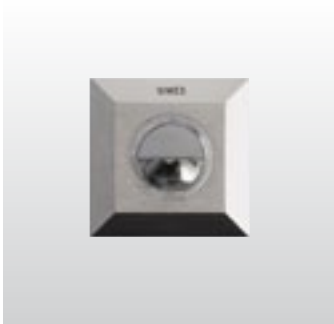

**S.3256.19** □  
With 1 led white 6000K 80lm  
Rated luminaire luminous flux 29lm

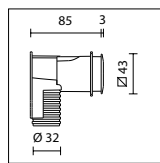

**S.3256W.19** □  
With 1 led white 3200K 60lm  
Rated luminaire luminous flux 20lm

Rated input power 1,25W 24V

Requires remote power supply  
240V/24V DC  
(type S.3400)

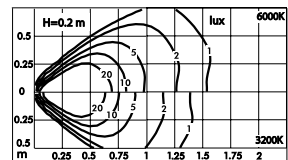
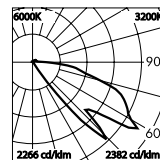

DOWN LIGHT - Opal diffuser

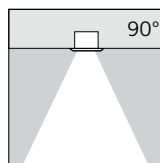

**S.3266.19** □  
With 1 led white 6000K 80lm  
Rated luminaire luminous flux 29lm

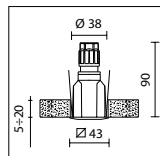

**S.3266W.19** □  
With 1 led white 3200K 60lm  
Rated luminaire luminous flux 18lm

Rated input power 1,25W 24V

Requires remote power supply  
240V/24V DC  
(type S.3400 or S.3422)

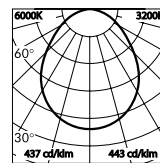

h(m)	90°	6000K	3200K
0.4	0.83	79	50
0.8	1.66	20	12
1.2	2.49	9	6
1.6	3.33	5	3
2.0	4.16	3	2



LEGO  
DESIGN

PILPO